

# Washer extractor

## W4850H, W41100H Hands-off System

### Features and benefits

- The hands-off System features a fully automatic loading and unloading process. Sling bags and conveyors must be designed individually and is not included in the system
- Forward tilting and backward tilting with full controlled reversing action
- Motor driven door and loading hopper
- Separate control panel
- High extraction force for efficient dewatering
- Clarus Control® fully programmable, microprocessor with up to 192 programs
- Large door opening for easy loading/unloading
- Prepared for 13 liquid detergent signals
- Eight liquid supply connections
- Stainless steel in all vital parts for high degree of rust protection
- Direct steam heating
- Frequency controlled motor for max. versatility
- Oil lubrication of bearing gaskets
- SuperBalance™ guarantees the correct extraction force

### Main options

- Noise/heat insulation, <70 dB(A)
- Test tap with level tube
- Dual drain valves for water/solvent recovery
- Five-compartment supply injector
- Third water valve
- Large water valves (DN 50/2")
- Integrated Weighing System™ (IWS)
- Oil lubrication of bearing gaskets with warning for empty container
- Connection of intelligent detergent systems (DMIS)



Main specifications		W4850H	W41100H
Max. capacity	kg/lb	90/200	120/250
Drum, volume	litre	850	1100
	diameter	1220	1220
Extraction	rpm	720	663
G-factor		350	300
Heating alternatives	steam	x	x
	non-heated	x	x
	electricity	–	–
<b>Consumption data "Normal 60°C" *</b>			
Total time	min	45	45
Water consumption (cold/hot)	litre	713/125	850/153
Energy consumption (motor)	kWh	2.3	2.4
Steam consumption	kg	10	12

\* Water temperature 15°C cold water and 65°C hot water.

Electrical connections*			W4850H	W41100H
Heating	Voltage			
Steam or non-heated	230V 3AC 50Hz	kW(A)	6.7 (25)	5.3 (25)
	230V 3AC 60Hz	kW(A)	6.7 (20)	5.3 (20)
	400-415V 3N AC 50 Hz	kW(A)	6.7 (16)	5.3 (16)
Water, steam and air connections				
Water valves	DN		40	40
Rec. Water pressure	kPa		200-600	200-600
Function limits for water valve	kPa		50-1000	50-1000
Capacity at 300 kPa	l/min		200	200
Drain valve	ø mm		110	110
Draining capacity	l/min		400	400
Steam valve	DN		32	32
Rec. Steam pressure	kPa		300-600	300-600
Function limits for steam valve	kPa		50-800	50-800
Compressed air	DN		6	6
Air pressure	kPa		500-700	500-700
Air consumption	l/h		20	20
Floor requirements				
Frequency of the dynamic force	Hz		12.0	11.1
Max floor load at extraction	kN		22±7.3	24±7.3
Sound levels				
Sound level	dB(A)		73	73
Sound level, with insulation	dB(A)		< 70	< 70
Heat emission				
% of installed power, max 90°			6.7	6.8
Shipping data				
Shipping volume	net, kg		2320	2420
	m <sup>3</sup>		8.6	9.4

\* Other voltages available, see installation manual.

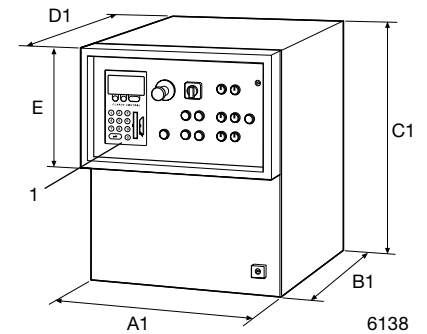

Control panel



Forward tilting, unloading



Backward tilting, loading

Dimensions in mm		W4850H	W41100H
A	Width	1640	1640
B	Depth	1635	1850
C	Height	3300	3300
D		2230	2230
E		1000	1000
F		660	660
G		125	125
H		380	380
I		1890	1890
K		850	850
L		620	620
M, max		610	610
N		110	110
O		1005	1005
P		2135	2135
R		1140	1140
S		1070	1070
T		830	830
U		635	635
V		445	445
X		1660	1660
Y		435	435
Z		820	820
A1		600	600
B1		350	350
C1		760	760
D1		390	390
E1		375	375

- 1 Control panel
- 2 Door opening  $\varnothing$  700
- 3 Soap supply injector, powder (optional)
- 4 Cold water connection
- 5 Hot water connection
- 6 Third water connection (optional)
- 7 Steam connection
- 8 Drain
- 9 Electrical connection
- 10 Compressed air
- 11 External liquid supply, 6 pcs  $\varnothing$  10, 1 pc  $\varnothing$  16 and 1 pc  $\varnothing$  20
- 12 Water connection, soap supply injector (optional)

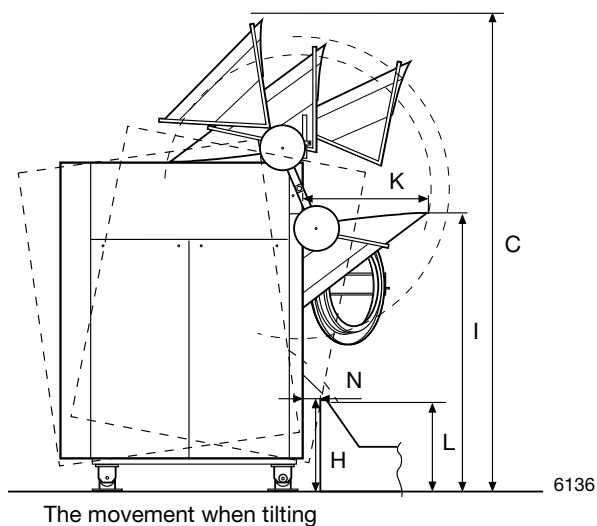
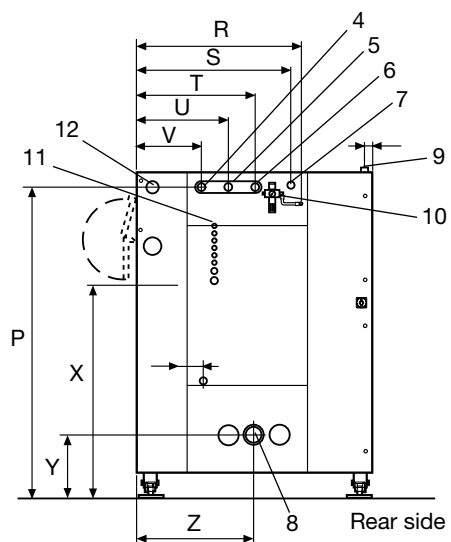
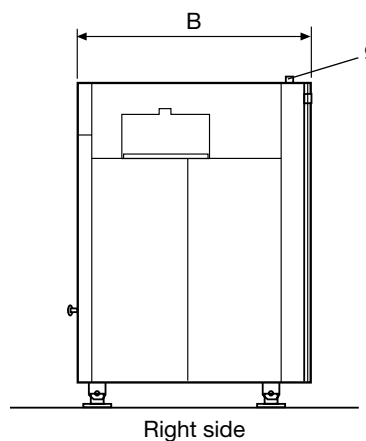
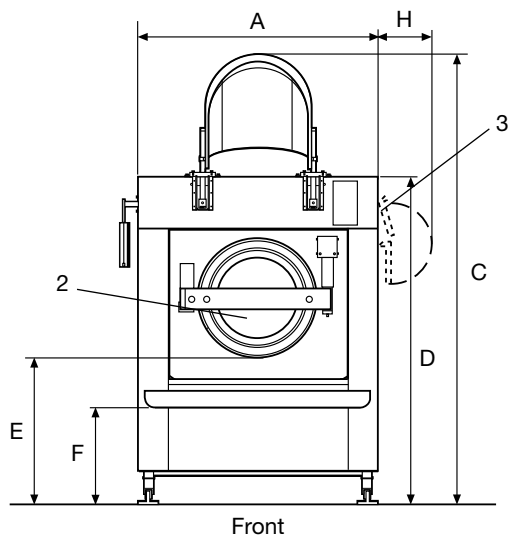
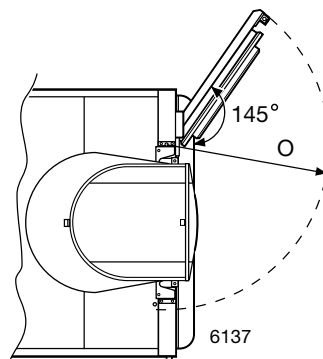

### Options

- Noise/heat insulation – reduce the airborne sound to less than 70 dB(A).
- Test tap with level tube – gives possibilities to take samples from the wash liquid.
- Water/solvent recovery system – two drain valves to be able to recover water from the rinses and reuse it in the wash.
- Five-compartment supply injector (5x2 litres), right hand side.
- Oil lubrication of bearing gaskets with warning for empty container.
- Large water valves (DN 50/2”).
- Connection of intelligent detergent system (DMIS).
- Third water valve - electrically controlled water valve for e.g hard water.
- Connection details for steam.
- Connection details for 2 water.
- Connection details for 3 water.
- External communication cable – cable for connecting a lap-top computer and be able to transfer data to and from the machine.
- Integrated Weighing System (IWS) – shows the weight of the load on the program display.

### Accessory

- Kit for connection to CMIS (Certus Management Information Systems) network. CMIS provides vital statistics, error codes, maintenance intervals, process receipt, etc.



CMIS can be fitted to washer extractors with Clarus Control, tumble dryers with Selecta Control and ironers with electronic control system. All you need to access and view the statistical feedback is a normal PC.